

**BORMANN**<sup>®</sup>

Technik



## **BWR5063 | ΕΡΓΑΛΕΙΟΦΟΡΕΑΣ**

**GR**

Μετάφραση του πρωτοτύπου των οδηγιών χρήσης

**GB**

Owner's manual

[www.BormannTools.com](http://www.BormannTools.com)



**PARTS INCLUDED:**

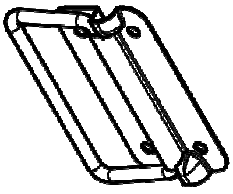

Handle---2



Screw ST4X8---8

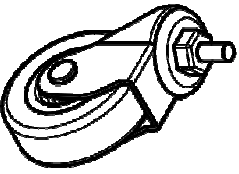

Caster---4

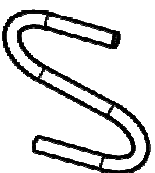

Hook---5

**WARNING**

- A) Do not open more than one loaded drawer at a time.
- B) The maximum loading capacity is 70kgs (154 lbs) .